

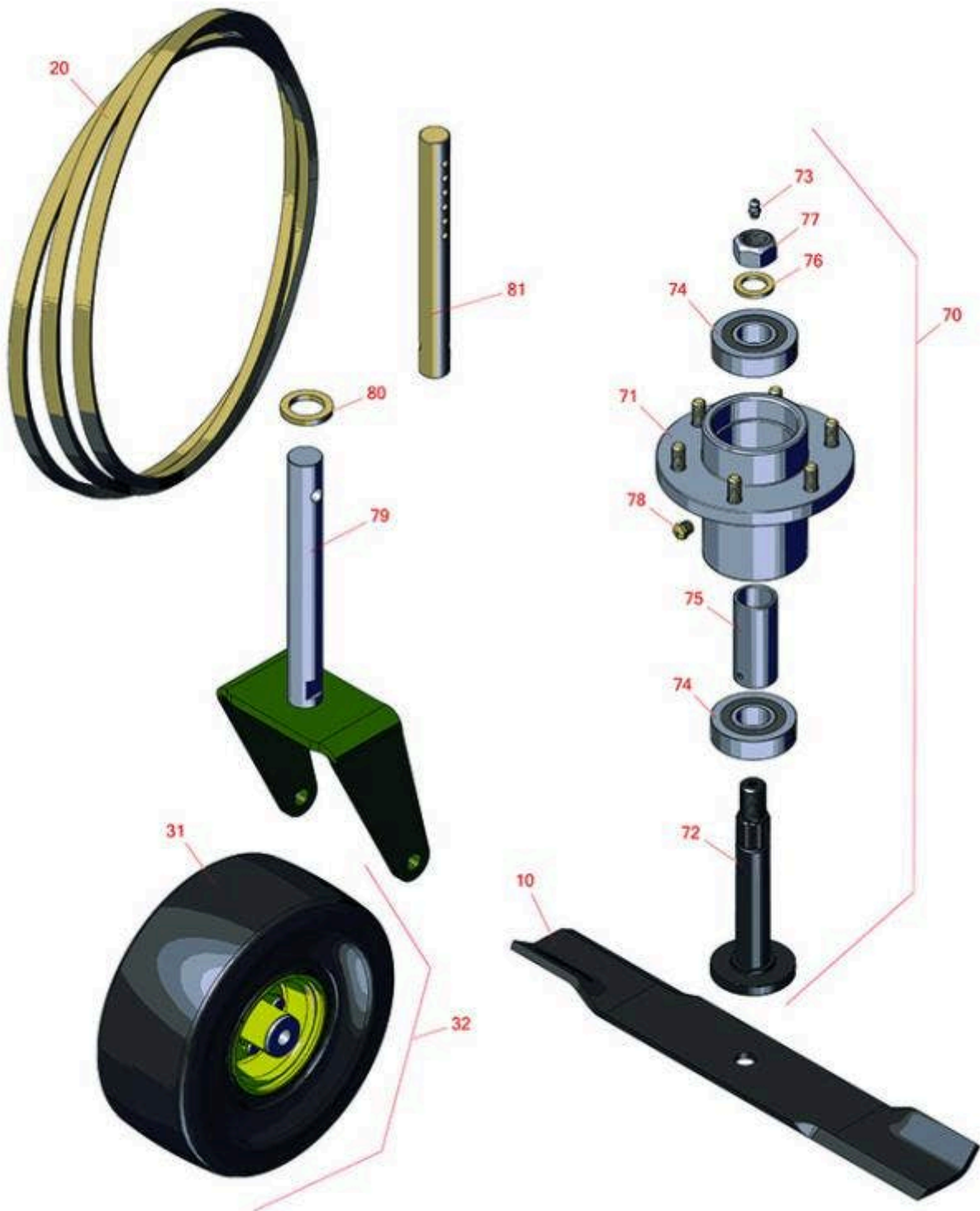

# Replaces John Deere WG32A Commercial Walk-Behind Mower Parts

Rotary Mower  
32in Deck Parts



All original equipment manufacturers names and part numbers are used for identification purposes only, and we are in no way implying that our products are original equipment parts. Prices subject to change without notice.



# Replaces John Deere WG32A Commercial Walk-Behind Mower Parts

Rotary Mower  
32in Deck Parts



Item No	R&R Part No.	OEM Part No.	Description	Qty Req	Order Quantity
<b>Rotary Blades</b>					
10	<b>RTCUC29299</b>	TCUC29299	Mower Blade 16.5 in	3	
<b>Belts</b>					
20	<b>RTCUC29158</b>	TCUC29158	Belt - V	1	
<b>Tires and Wheels</b>					
31	<b>RTCUC32225</b>	TCA20508, TCUC32225	Tire - 9x3:50-4 Poly Smooth	2	
32	<b>RTCA22217</b>	TCA22217	Tire & Wheel - 9x3.50-4 Smooth Poly	2	
<b>Other Parts Available</b>					
70	<b>RTCA20480</b>	TCA20480	Spindle Assy	3	
71	<b>RTCA20479</b>	TCA20479	Spindle Housing	3	
72	<b>RTCUC29122</b>	TCUC29122	Shaft Spindle	3	
73	<b>R302-5</b>	JD7797, JD7842, JD7844	Fitting - Grease	3	
74	<b>RJD9467</b>	JD9467	Bearing	6	
75	<b>RTCUC29463</b>	TCUC29463	Spacer	3	
76	<b>RM82056</b>	M82056	Washer - 19.050 x 28.575 x 3.038 mm	3	
77	<b>RD24008</b>	D24008	Nut - 3/4-16 Top Lock All Metal	3	
78	<b>R170714</b>	E14814	Fitting - Pressure Relief	3	
79	<b>RTCA20535</b>	TCA20535	Yoke	2	
80	<b>RTCUC29291</b>	TCUC29291	Bushing	2	
81	<b>RTCUC29131</b>	TCUC29131	Rod - Front	2	

All original equipment manufacturers names and part numbers are used for identification purposes only, and we are in no way implying that our products are original equipment parts. Prices subject to change without notice.