

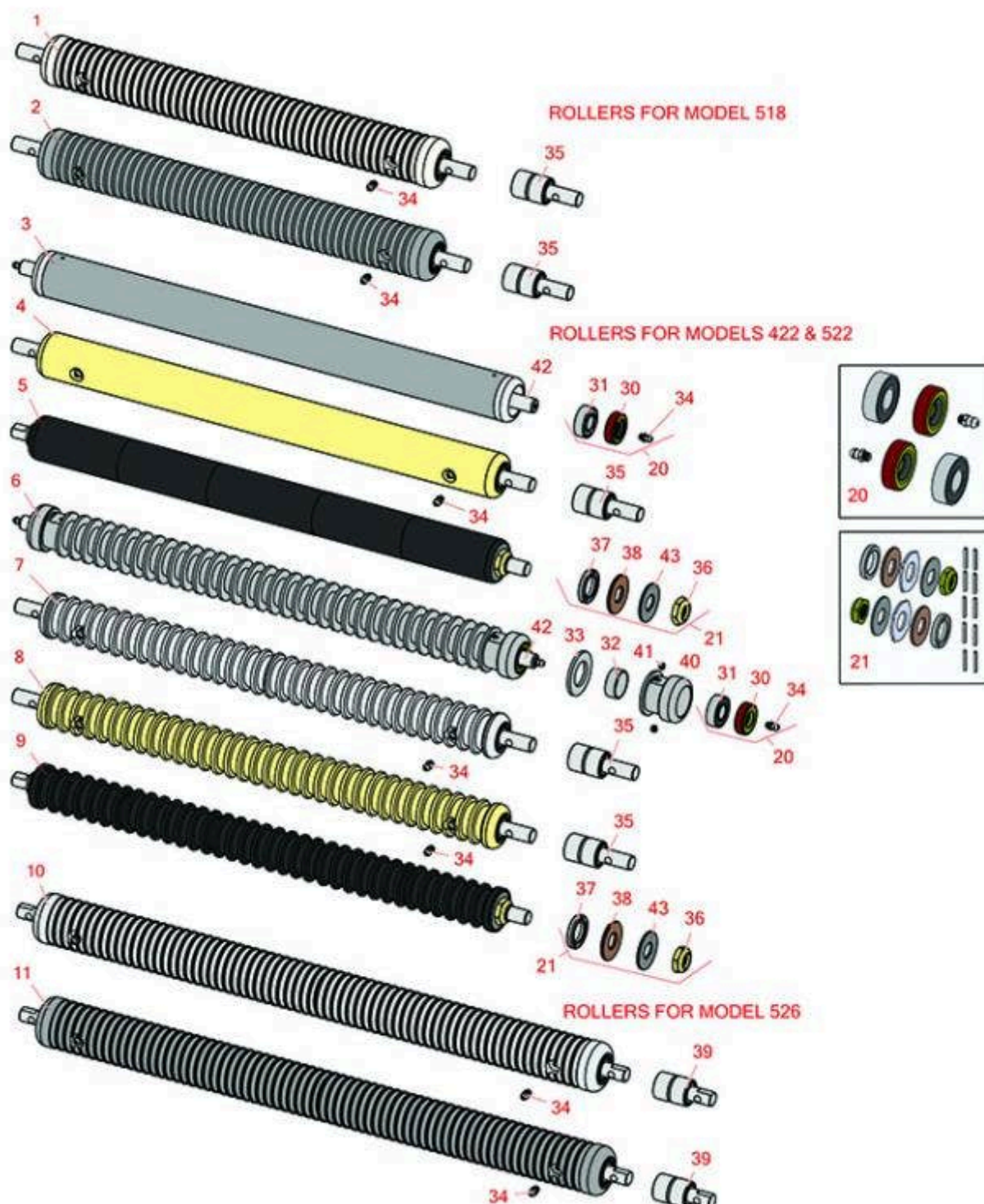

Replaces Jacobsen Greens King 522

Parts

Cutting Unit
Rollers



All original equipment manufacturers names and part numbers are used for identification purposes only, and we are in no way implying that our products are original equipment parts. Prices subject to change without notice.



Replaces Jacobsen Greens King 522

Parts

Cutting Unit
Rollers



Item No	R&R Part No.	OEM Part No.	Description	Qty Req	Order Quantity
---------	--------------	--------------	-------------	---------	----------------

R&R Rollers to fit 518

1	R101129	68618	Roller - Grooved Machined Aluminum	1	
---	----------------	-------	------------------------------------	---	--

Detail Description: Machined from solid aluminum, this roller uses greasable "water-pump" style bearings.:

2	R101130	68616	Roller - Grooved Solid Steel	1	
---	----------------	-------	------------------------------	---	--

Detail Description: Machined from solid steel, this heavy weight roller uses greasable "water-pump" style bearings.:

R&R Rollers to fit 422 & 522

3	R158776	158776, 162917	Roller - Smooth Tubular Steel	1	
---	----------------	-------------------	-------------------------------	---	--

Detail Description: Constructed with a through shaft and greasable ball bearings.:

4	R101126		Roller - Smooth Solid Steel	1	
---	----------------	--	-----------------------------	---	--

Detail Description: Machined from solid steel, this heavy weight roller uses greasable "water-pump" style bearings.:

5	R101336		Roller - Smooth UHMW Polyethylene	1	
---	----------------	--	-----------------------------------	---	--

Detail Description: Machined from solid UHMW, this low maintenance roller uses a 1" solid stainless steel shaft and requires no grease. UHMW material prevents build-up of debris.:

6	R68527R		Roller - Grooved Repairable Steel	1	
---	----------------	--	-----------------------------------	---	--

Detail Description: Constructed with a through shaft and greasable ball bearings, this roller can be repaired by unscrewing the ends and replacing the series of washers and spacers.:

7	R101123		Roller - Grooved Machined Solid Aluminum	1	
---	----------------	--	--	---	--

Detail Description: Machined from solid aluminum, this lightweight roller uses greasable "water-pump" style bearings.:

8	R68577	68577	Roller - Grooved Machined Solid Steel	1	
---	---------------	-------	---------------------------------------	---	--

All original equipment manufacturers names and part numbers are used for identification purposes only, and we are in no way implying that our products are original equipment parts. Prices subject to change without notice.



Replaces Jacobsen Greens King 522

Parts

Cutting Unit
Rollers



Item No	R&R Part No.	OEM Part No.	Description	Qty Req	Order Quantity
---------	--------------	--------------	-------------	---------	----------------

Detail Description: Machined from solid steel, this heavyweight roller uses greasable "water-pump" style bearings.:

9	R101330		Roller - Grooved UHMW Polyethylene	1	
---	----------------	--	------------------------------------	---	--

Detail Description: Machined from solid UHMW, this low maintenance roller rotates around a 1" solid stainless steel shaft and requires no bearings or grease. Patented groove design and smooth UHMW material prevents build-up of debris.:

R&R Rollers to fit 526

10	R101127	67617	Roller - Grooved Machined Aluminum	1	
----	----------------	-------	------------------------------------	---	--

Detail Description: Machined from solid aluminum, this roller uses greasable "water-pump" style bearings.:

11	R101128	68628	Roller - Grooved Machined Solid Steel	1	
----	----------------	-------	---------------------------------------	---	--

Detail Description: Machined from solid steel, this heavy weight roller uses greasable "water-pump" style bearings.:

Overhaul Kits

20	R100130	100130	Overhaul Kit - Roller	1	
----	----------------	--------	-----------------------	---	--

Detail Description: Includes 2 ea.: R302-5 Grease Fittings, R303558 Bearings, & R305115 Seals:

21	R101395	100139, 101395	Overhaul Kit - UHMW Roller	1	
----	----------------	-------------------	----------------------------	---	--

Detail Description: Fits all R&R 2" Dia. Black UHMW Polyethylene Rollers. Includes 10 ea.: R150322 Roll Pins; 2 ea.: R3296-15 Locknuts, R150347T Teflon Seals, R150333 Thrust Washers, & R150334A Bronze Thrust Washers:

Other Parts Available

30	R305115	305115	Seal - Roller	2	
31	R303558	303558	Bearing - Roller	2	
32	R150651		Spacer - 2-3/8 Roller	34	

All original equipment manufacturers names and part numbers are used for identification purposes only, and we are in no way implying that our products are original equipment parts. Prices subject to change without notice.



Replaces Jacobsen Greens King 522

Parts

Cutting Unit
Rollers



Item No	R&R Part No.	OEM Part No.	Description	Qty Req	Order Quantity
33	R150652	150652, 325262	Washer - 2 Roller	33	
34	R302-5	302-5, 471214, 471223, 471226	Fitting - Grease	2	
35	R101481	101481, 311839	Bearing - Roller	2	
<i>Detail Description: Fits R&R Machined Grooved Roller & Smooth (19 lbs) Roller:</i>					
36	R3296-15	3296-15, 367029, 444742	Locknut - 3/4-16 Nylon Jam	2	
37	R150347T		Seal - Nonstick Lip	2	
38	R150334A		Washer - Thrust SAE660 Bronze	2	
39	R75-1290	75-1290	Bearing - Roller	2	
40	R150650		Roller End - 2 Repairable	2	
41	R150690	150690, 415509	Screw - Set 1/4-20 x 1/4	4	
42	R102030	102030	Shaft - Front Roller	1	
43	R150333		Washer - Flat Keyed Outer SS	2	

All original equipment manufacturers names and part numbers are used for identification purposes only, and we are in no way implying that our products are original equipment parts. Prices subject to change without notice.