

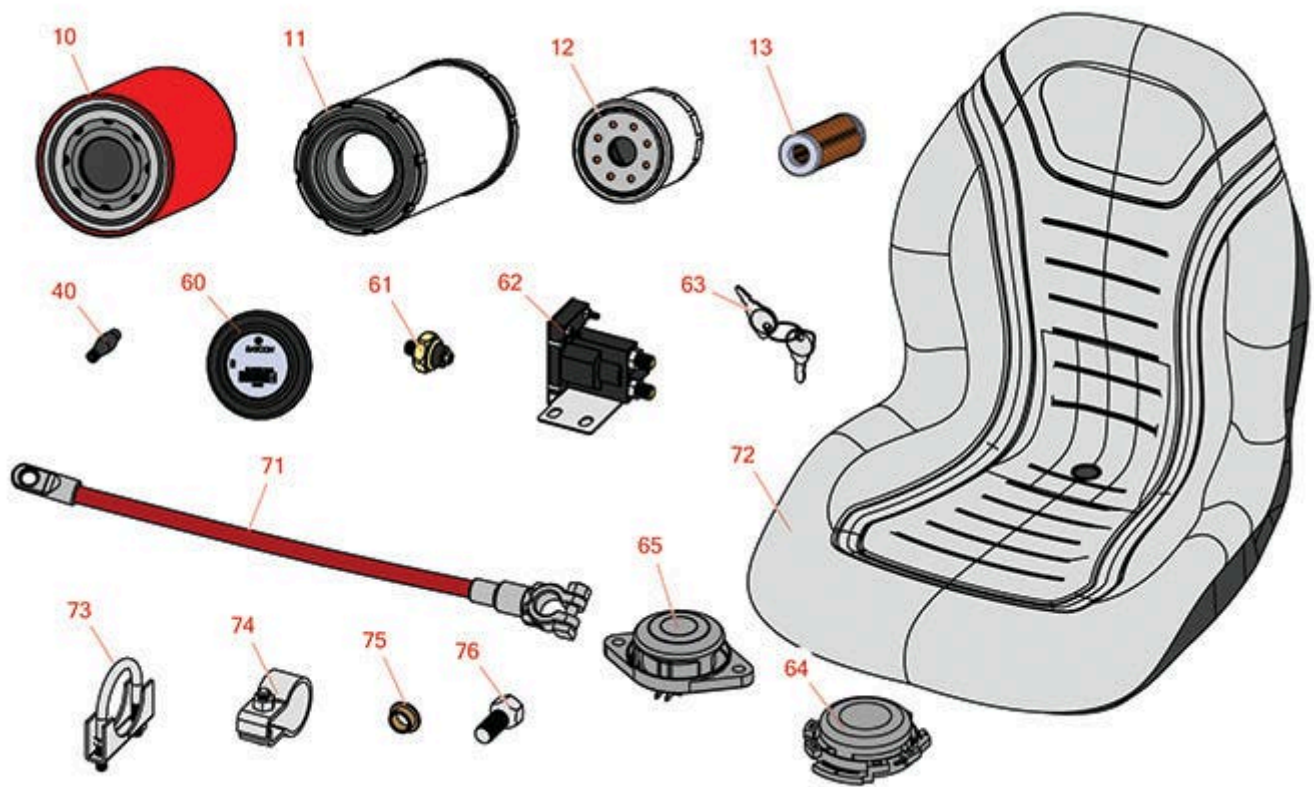

## Replaces Jacobsen Tri-King 1900D Parts

Traction Unit  
Traction Unit



All original equipment manufacturers names and part numbers are used for identification purposes only, and we are in no way implying that our products are original equipment parts. Prices subject to change without notice.



# Replaces Jacobsen Tri-King 1900D Parts

Traction Unit  
Traction Unit



Item No	R&R Part No.	OEM Part No.	Description	Qty Req	Order Quantity
<b>Filters</b>					
10	<b>R86-3010</b>	108046, 281370, 522972, 549587, 549597, 925023	Baldwin Hydraulic Oil Filter	1	
11	<b>R93-2195</b>	0840352, 5000913	Baldwin Air Filter	1	
11	<b>RRF10125</b>		SilverGuard Air Filter	1	
12	<b>RRF10635</b>	5002644	SilverGuard Oil Filter	1	
12	<b>RX1585332430</b>	5002644	Kubota Filter - Oil	1	
13	<b>R550489</b>	1523143560, 1523143563, 5001190, 550489	Baldwin Fuel Filter	1	
13	<b>RRF10517</b>	550489	SilverGuard Fuel Filter	1	
<b>Tires</b>					
40	<b>R232-27</b>	232-27, 360111	Stem - Valve w/ Cap	3	
<b>Gauges and Controls</b>					
60	<b>R162723</b>	162723, 358825	Meter - Hour	1	
61	<b>RX1584139010</b>	554018	Kubota Switch - Oil	1	
62	<b>R131905</b>	126070, 131905	Solenoid - Starter	1	
63	<b>R343060</b>	343060, 5000039	Ignition - Key Set/2	1	

All original equipment manufacturers names and part numbers are used for identification purposes only, and we are in no way implying that our products are original equipment parts. Prices subject to change without notice.



# Replaces Jacobsen Tri-King 1900D Parts

Traction Unit  
Traction Unit



Item No	R&R Part No.	OEM Part No.	Description	Qty Req	Order Quantity
64	R151541		Delta Seat Switch - Twist Mount 1 Pole Normally Open	1	
65	R92-6282	554390	Switch - Kill - Seat	1	
<b>Other Parts Available</b>					
71	R340712	340712	Cable - Battery Positive	1	
72	RMXB200GY	1001774, 66172	Milsco Seat XB200 - Grey	1	
<i>Tech Note: This seat will not accept seat belts:</i>					
<i>Detail Description: The Milsco XB200 high back seat features a comfortable vacuum formed, waterproof vinyl cover with central drain hole. Ergonomic foam cushion provides operator comfort. Cover will not crack or peel. Rugged blow-molded plastic frame construction. Allows for Twist-in operator presence switch. Seat: 19in W x 24in D x 21in H. Multiple pre-drilled mounting patterns. Grey. Made in U.S.A.&lt;BR&gt;Please note: Due to excessive air freight charges, this item will be shipped ground freight.:</i>					
73	R348856	348856	Clamp - Muffler - 1-1/2	1	
74	R364902	364902	Clamp - Torsion Spring 1-3/8	1	
75	R352936	352936	Bushing - Bronze	1	
76	R353914	353914	Bolt - Wheel	8	

All original equipment manufacturers names and part numbers are used for identification purposes only, and we are in no way implying that our products are original equipment parts. Prices subject to change without notice.