



Replaces R&R Products Sand Max 416

Parts

Attachments

Weeder Tine Toolbar

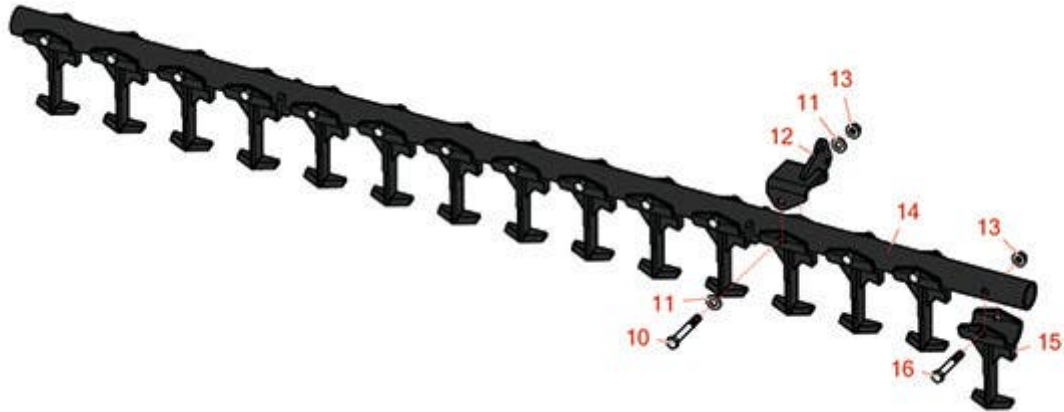

All original equipment manufacturers names and part numbers are used for identification purposes only, and we are in no way implying that our products are original equipment parts. Prices subject to change without notice.



Replaces R&R Products Sand Max 416

Parts

Attachments

Weeder Tine Toolbar



Item No	R&R Part No.	OEM Part No.	Description	Qty Req	Order Quantity
10	R323-14	323-14, R01-150-0840, R01-178-0624, R20-55-AD, R21-196-AMD, R30-8750, R30-8970, R3224-10	Bolt - Hex HD 3/8-16 x 3	1	
11	R453011	3256-24, 453011, R01-166-0100, R01-166-0120, R01-166-0270, R01-166-0500, R01-166-0600, R01-166-0620, R132-4593, R237-12, R24-10-AD, R24-11-AD, R24-11-BD, R24-12-AD, R24-12-BD, R30-9310, R32-8190, R3256-24, R3256-3, R3256-36, R3256-4, R47-9950	Washer - Flat 3/8 SAE Y/Zinc	2	
12	R112-6468-03		Bracket Assy - Tool Bar	1	
13	R3296-39	3296-39, R32127-25, R32128-36, R3296-17, R3296-22, R915663P, R99-7443	Locknut - 3/8-16 Nylon	15	
14	R108-4527-03		Tool Bar Assy	1	
15	R110-0260-03		Weeder Tine - Hardened	15	

All original equipment manufacturers names and part numbers are used for identification purposes only, and we are in no way implying that our products are original equipment parts. Prices subject to change without notice.



Replaces R&R Products Sand Max 416 Parts

Attachments

Weeder Tine Toolbar



Item No	R&R Part No.	OEM Part No.	Description	Qty Req	Order Quantity
16	R400274	R01-178-0626, R112-7161, R3224-11, R323-20	Bolt - Hex HD 3/8-16 x 2-1/2 GR5	14	

All original equipment manufacturers names and part numbers are used for identification purposes only, and we are in no way implying that our products are original equipment parts. Prices subject to change without notice.