

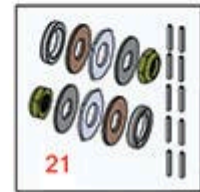

# Replaces R&R Products Versa-Green

## 1860 Parts

Dual Adjust Cutting Unit  
Rollers

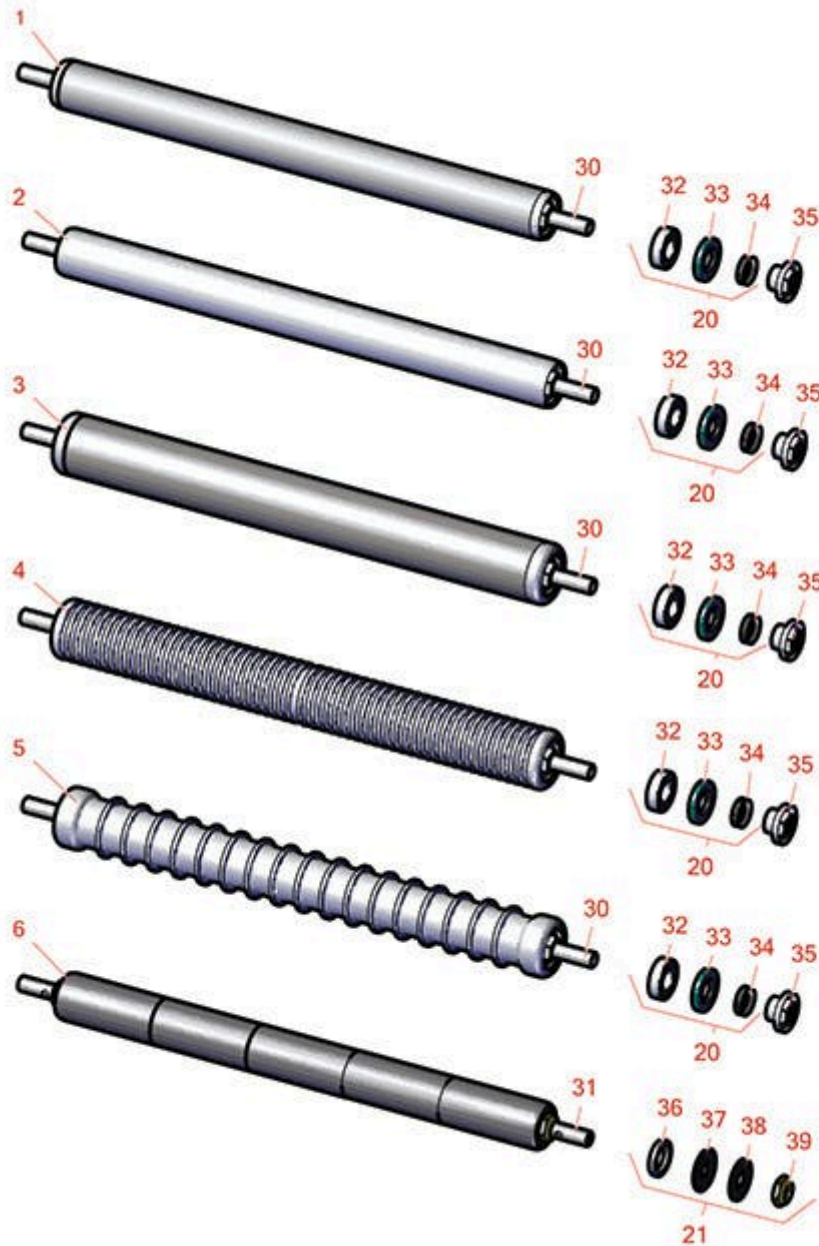

All original equipment manufacturers names and part numbers are used for identification purposes only, and we are in no way implying that our products are original equipment parts. Prices subject to change without notice.



# Replaces R&R Products Versa-Green

## 1860 Parts

Dual Adjust Cutting Unit  
Rollers



| Item No | R&R Part No. | OEM Part No. | Description | Qty Req | Order Quantity |
|---------|--------------|--------------|-------------|---------|----------------|
|---------|--------------|--------------|-------------|---------|----------------|

### R&R Rollers

|  |                  |   |   |   |  |
|--|------------------|---|---|---|--|
| 1  | <b>R140-5560</b> | R105-5776,<br>R106-6945,<br>R107-3509,<br>R119-4093,<br>R120-9595 | Roller - Smooth 2 in Steel Rear           | 1 |  |
| 2  | <b>R107-9036</b> | R107-7632   | Roller - Smooth Tubular Aluminum          | 1 |  |
| <i>Detail Description: Constructed with a through shaft, this light weight aluminum roller uses a through shaft and ball bearings.:</i>  |                  |   |   |   |  |
| 3  | <b>R107-9039</b> | R104-9796,<br>R106-2612,<br>R107-3500                             | Roller - Smooth Tubular Steel             | 1 |  |
| <i>Detail Description: Constructed with a through shaft, this steel roller uses a through shaft and ball bearings.:</i>  |                  |   |   |   |  |
| 4  | <b>R107-9037</b> | R106-2628,<br>R106-6944   | Roller - Narrow Grooved Machined Aluminum | 1 |  |
| <i>Detail Description: Constructed with a through shaft, this aluminum roller is machined with narrow grooves and uses ball bearings.:</i>   |                  |   |   |   |  |
| 5  | <b>R107-9038</b> | R106-2627,<br>R99-6215  | Roller - Wide Grooved Machined Aluminum   | 1 |  |
| <i>Detail Description: Constructed with a through shaft, this aluminum roller is machined with 1-1/8" wide grooves for the least amount of ground contact and uses ball bearings.:</i>     |                  |   |   |   |  |
| 6  | <b>R150340</b>   |   | Roller - Smooth UHMW Polyethylene         | 1 |  |
| <i>Detail Description: Machined from solid UHMW, this low maintenance roller uses a 1" solid stainless steel shaft and requires no grease. UHMW material prevents build-up of debris.:</i> |                  |   |   |   |  |

### Overhaul Kits

|  |                  |  |                            |   |  |
|--|------------------|--|----------------------------|---|--|
| 20   | <b>R107-1594</b> |  | Overhaul Kit - Roller      | 0 |  |
| <i>Detail Description: Includes 2 ea.: R106-6941 Seals, R106-6942 V-Rings &amp; R251-347 Bearings:</i> |                  |  |                            |   |  |
| 21   | <b>R101395</b>   |  | Overhaul Kit - UHMW Roller | 0 |  |

All original equipment manufacturers names and part numbers are used for identification purposes only, and we are in no way implying that our products are original equipment parts. Prices subject to change without notice.



# Replaces R&R Products Versa-Green

## 1860 Parts

Dual Adjust Cutting Unit  
Rollers



| Item No | R&R Part No. | OEM Part No. | Description | Qty Req | Order Quantity |
|---------|--------------|--------------|-------------|---------|----------------|
|---------|--------------|--------------|-------------|---------|----------------|

*Detail Description: Fits all R&R 2" Dia. Black UHMW Polyethylene Rollers. Includes 10 ea.: R150322 Roll Pins; 2 ea.: R3296-15 Locknuts, R150347T Teflon Seals, R150333 Thrust Washers, & R150334A Bronze Thrust Washers:*

### Other Parts Available

|    |           |  |                               |   |
|----|-----------|--|-------------------------------|---|
| 30 | R119-4090 |  | Shaft - Roller - Hardened     | 1 |
| 31 | R150336   |  | Shaft - 1 SS Front Roller     | 1 |
| 32 | R251-347  | R72-5690   | Bearing - Ball                | 2 |
| 33 | R106-6941 |  | Seal - Double Lip             | 2 |
| 34 | R106-6942 |  | V-Ring - Roller               | 2 |
| 35 | R114-3745 | 114-5411,<br>R106-6939,<br>R108-3151,<br>R114-5411   | Locknut - Bearing - Stainless | 2 |
| 36 | R150347T  | R150347  | Seal - Nonstick Lip           | 2 |
| 37 | R150334A  |  | Washer - Thrust SAE660 Bronze | 2 |
| 38 | R150333   | R150447  | Washer - Flat Keyed Outer SS  | 2 |
| 39 | R3296-15  | 367029,<br>R1503473,<br>R32118-5,<br>R32127-23,<br>R32127-47,<br>R367029,<br>R445748,<br>RG-371,<br>RN101345 | Locknut - 3/4-16 Nylon Jam    | 2 |

All original equipment manufacturers names and part numbers are used for identification purposes only, and we are in no way implying that our products are original equipment parts. Prices subject to change without notice.